

FINISHED ASSEMBLY

Steel partition with two sliding doors

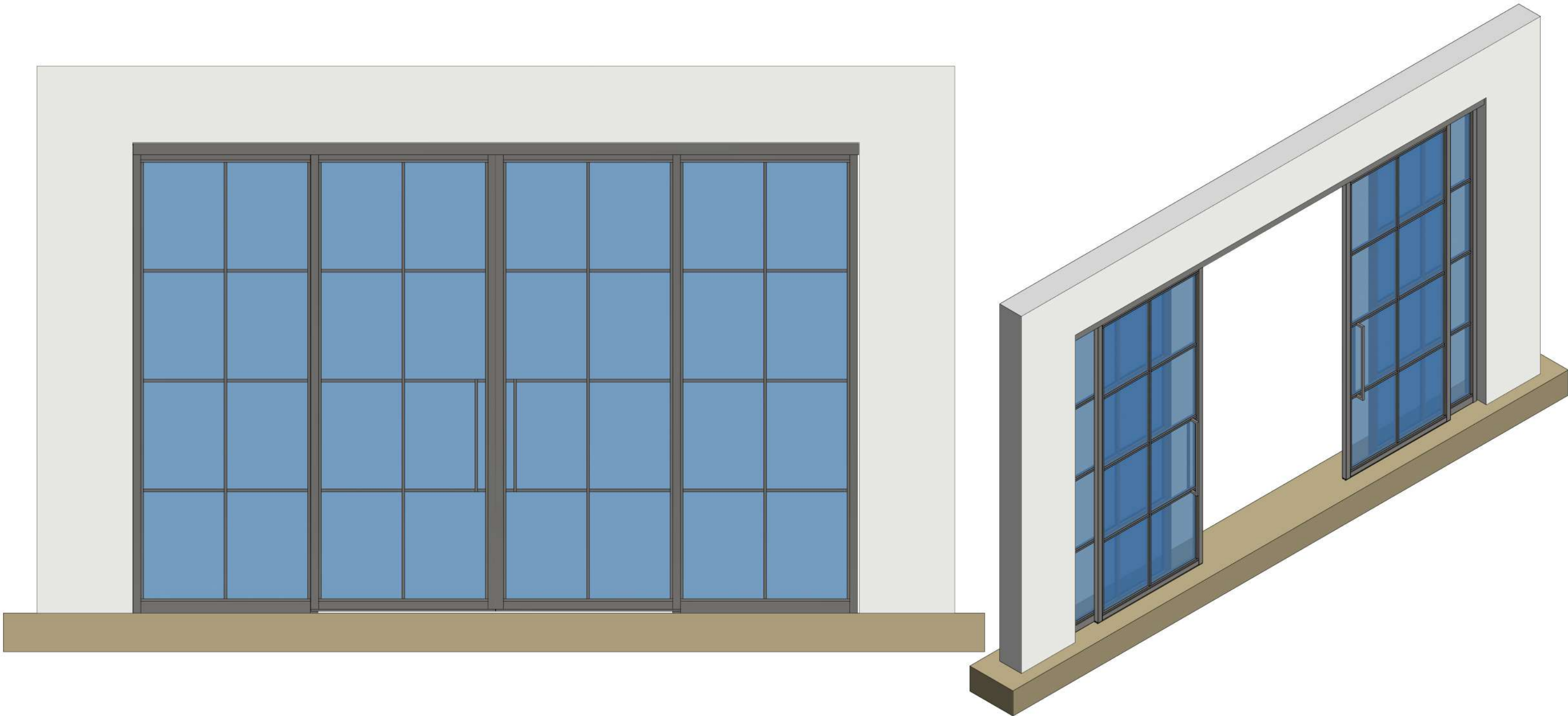

COMPOSITION

- 1- Guide bar (Compound if necessary)
- 2- Sliding door system
- 3- Fixed parts
- 4- Sliding doors' leaves
- 5- Fixed parts' glass
- 6- Sliding doors' glass
- 7- Fixed parts' glass frames
- 8- Doors' glass frames

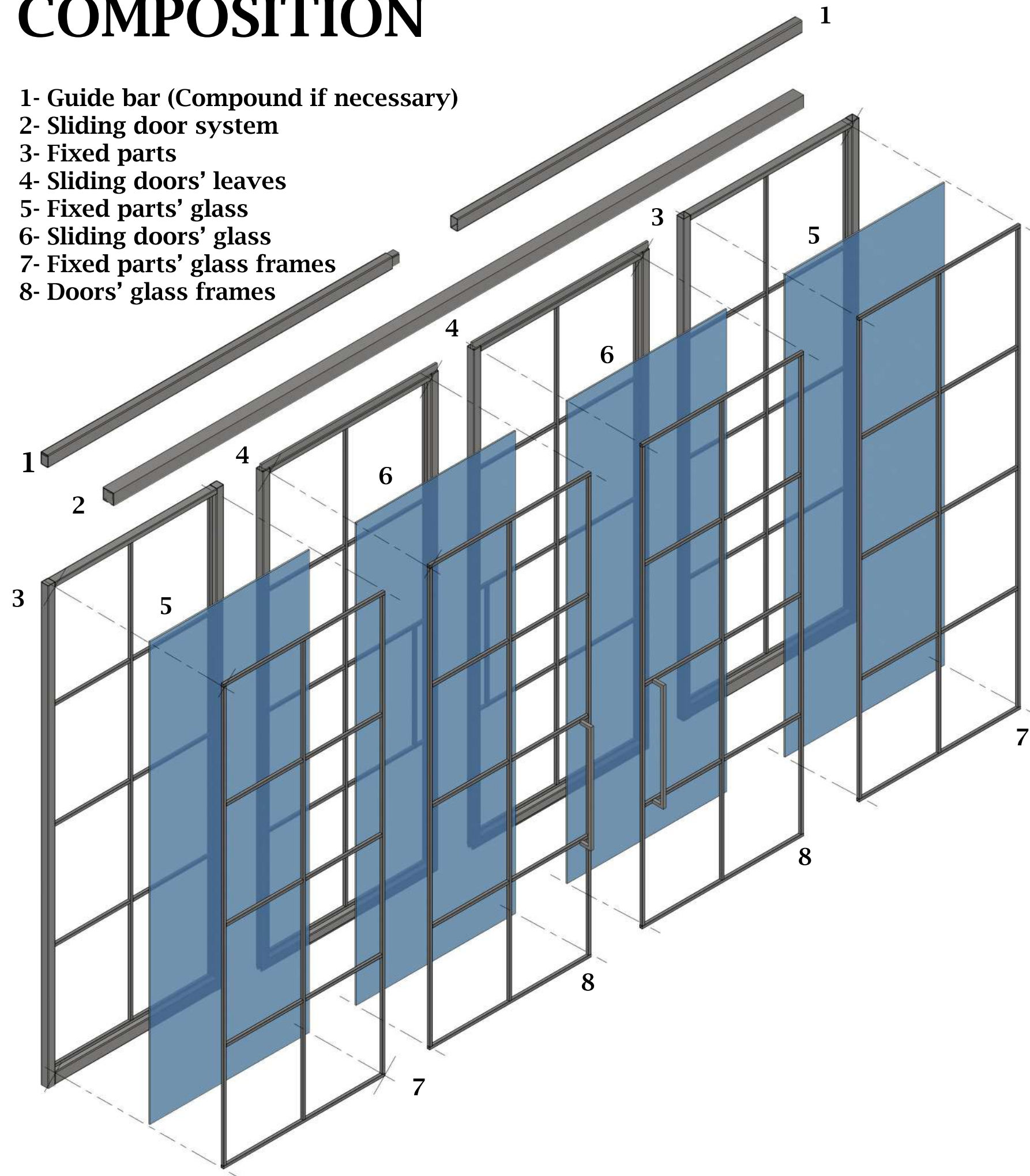

Required tools to install

-Drill



-Electric screwdriver



-Level instrument



-Stepladder



-Tape Measure



-Silicone sealer



STEP 1

PREPARATION THE GUIDE BAR

Connect the parts of a guide bar if it's not integral

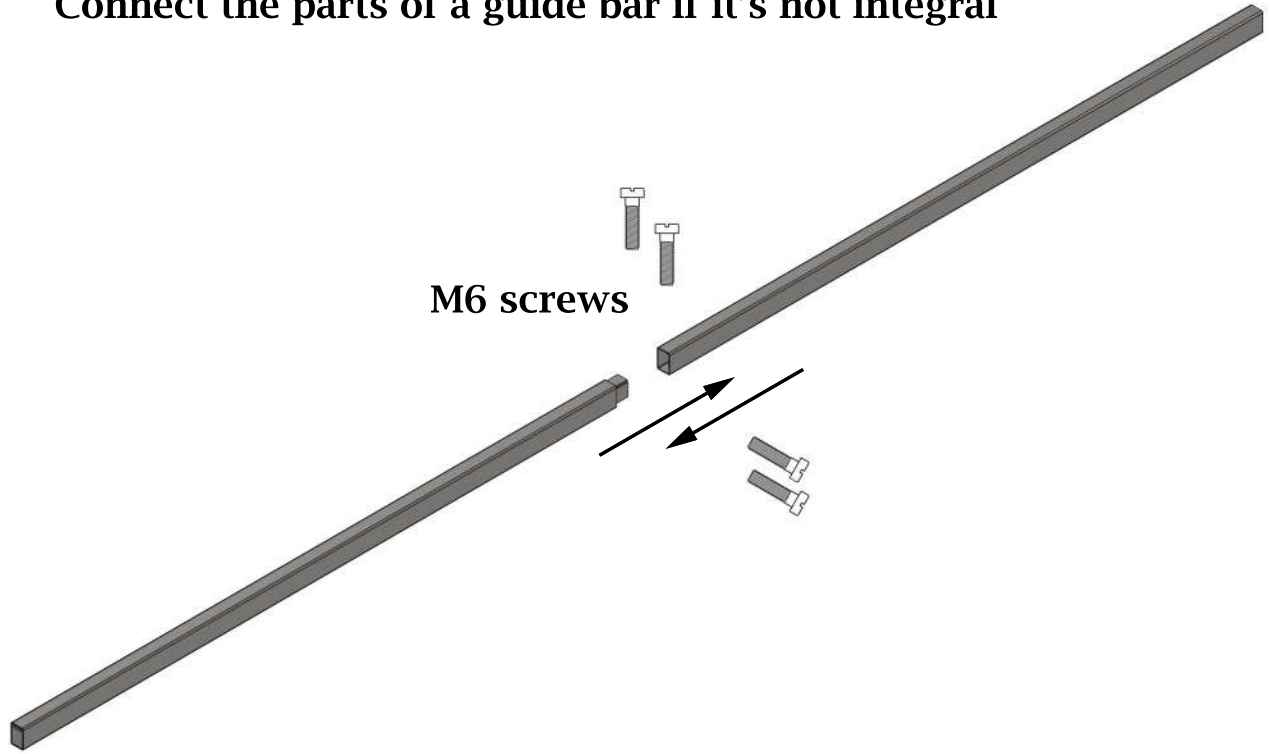

STEP 2

GUIDE BAR INSTALLATION

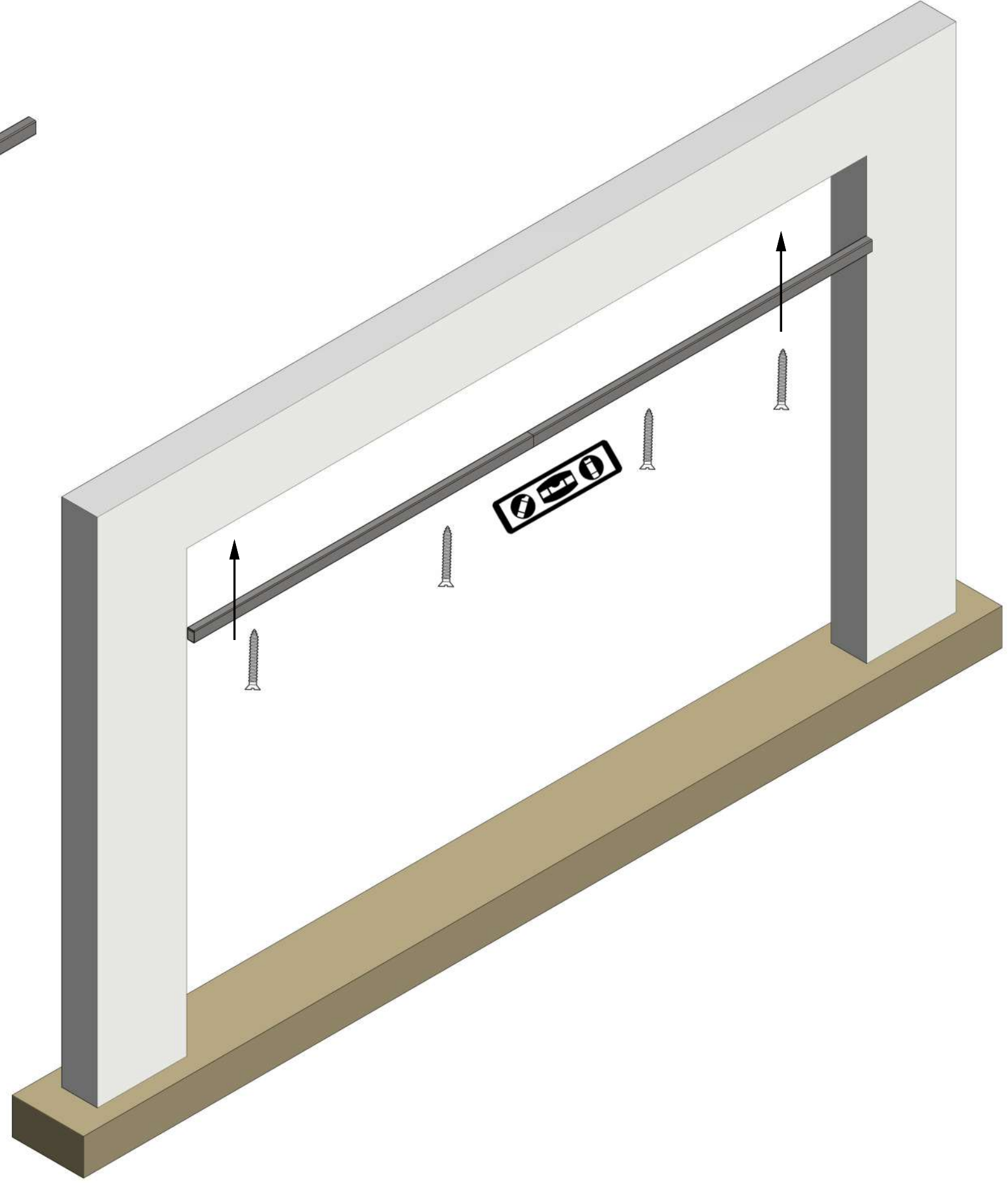

STEP 3

POSITIONING THE FIXED PARTS

Insert the fixed parts under the guide bar and match the holes

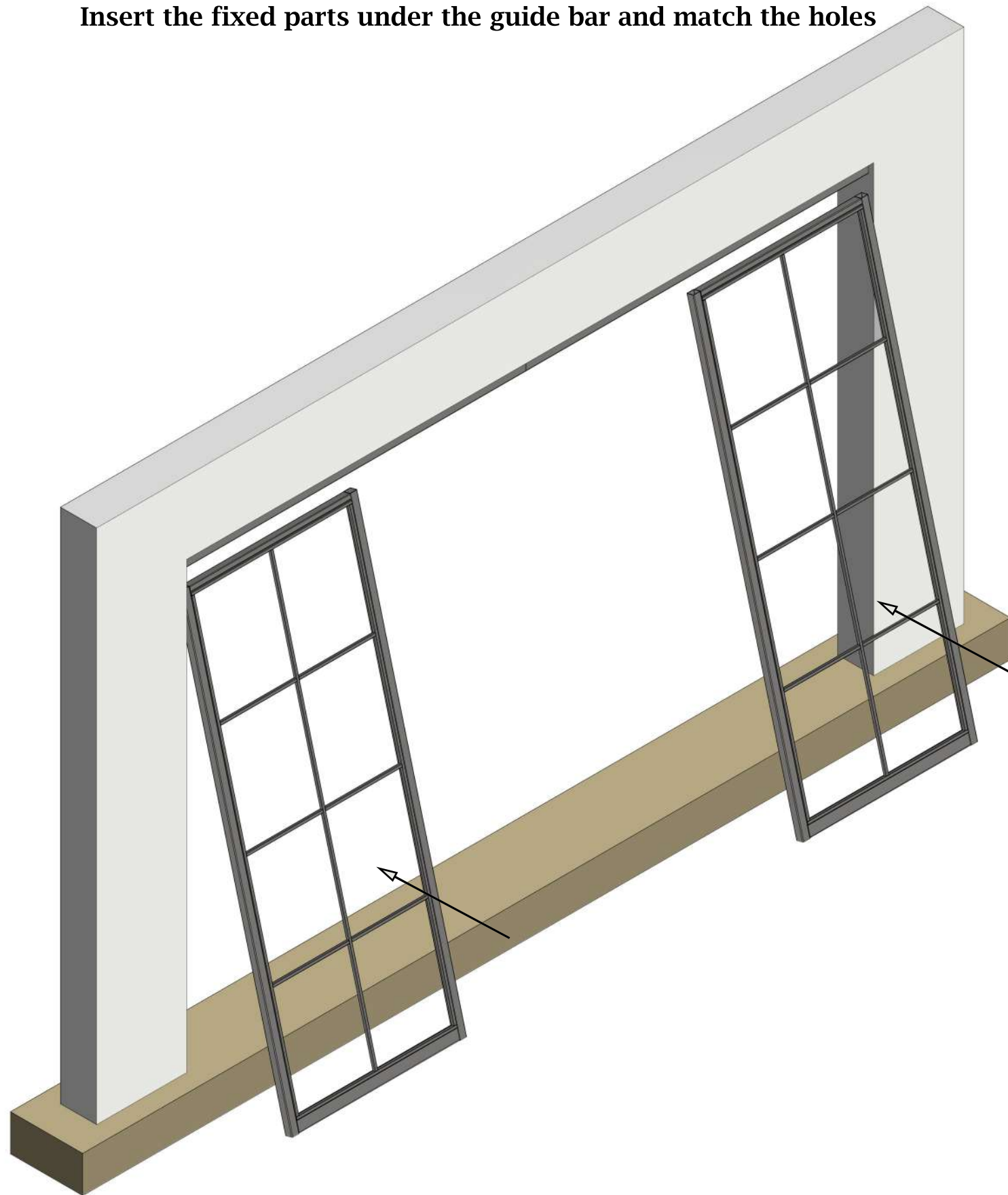

STEP 4

FIXATION THE FIXED PARTS WITH THE GUIDE BAR

Connect the fixed parts with the guide bar using M6 screws.
Adjust the clearance between the guide bar and the ceiling/wall by unscrewing it if necessary.
The fixed parts must be completely connected to the guide bar.

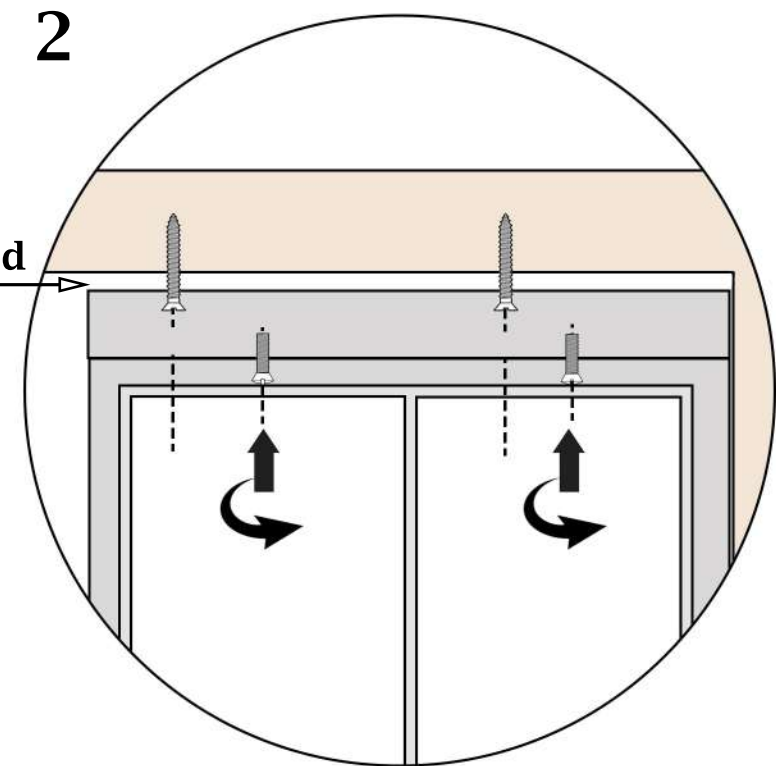
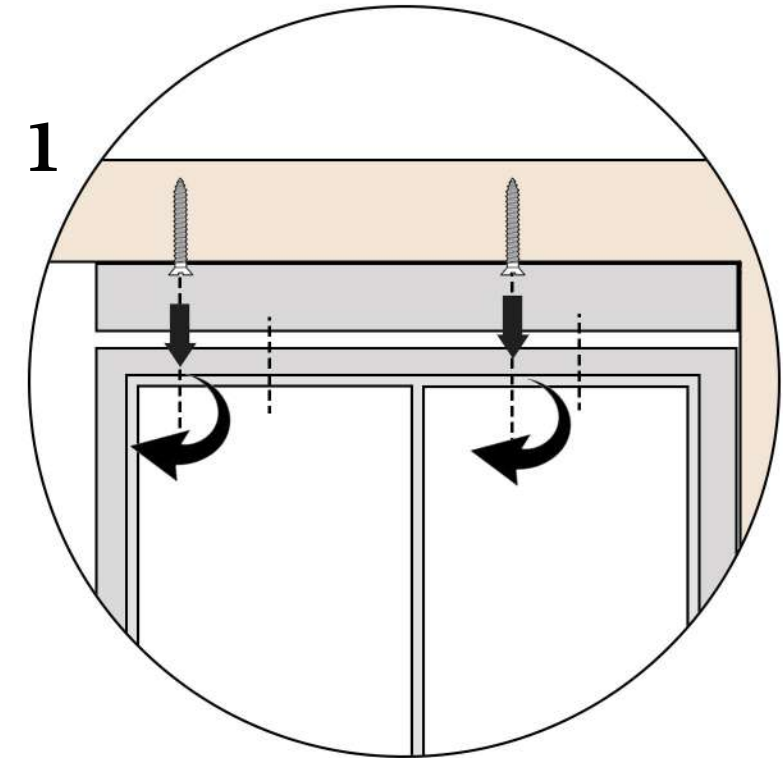
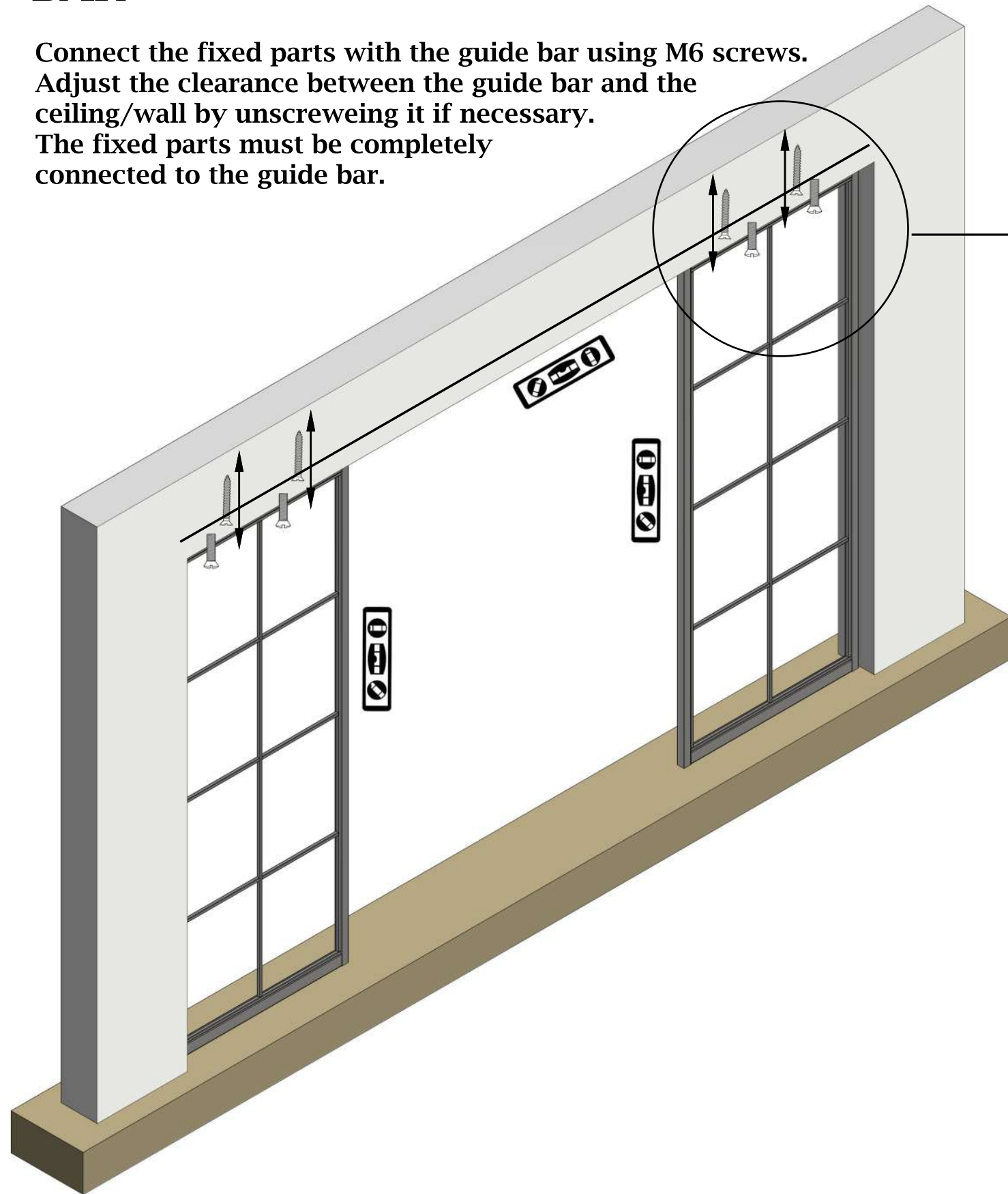

STEP 5

FIXATION THE FIXED PARTS WITH WALLS AND FLOOR

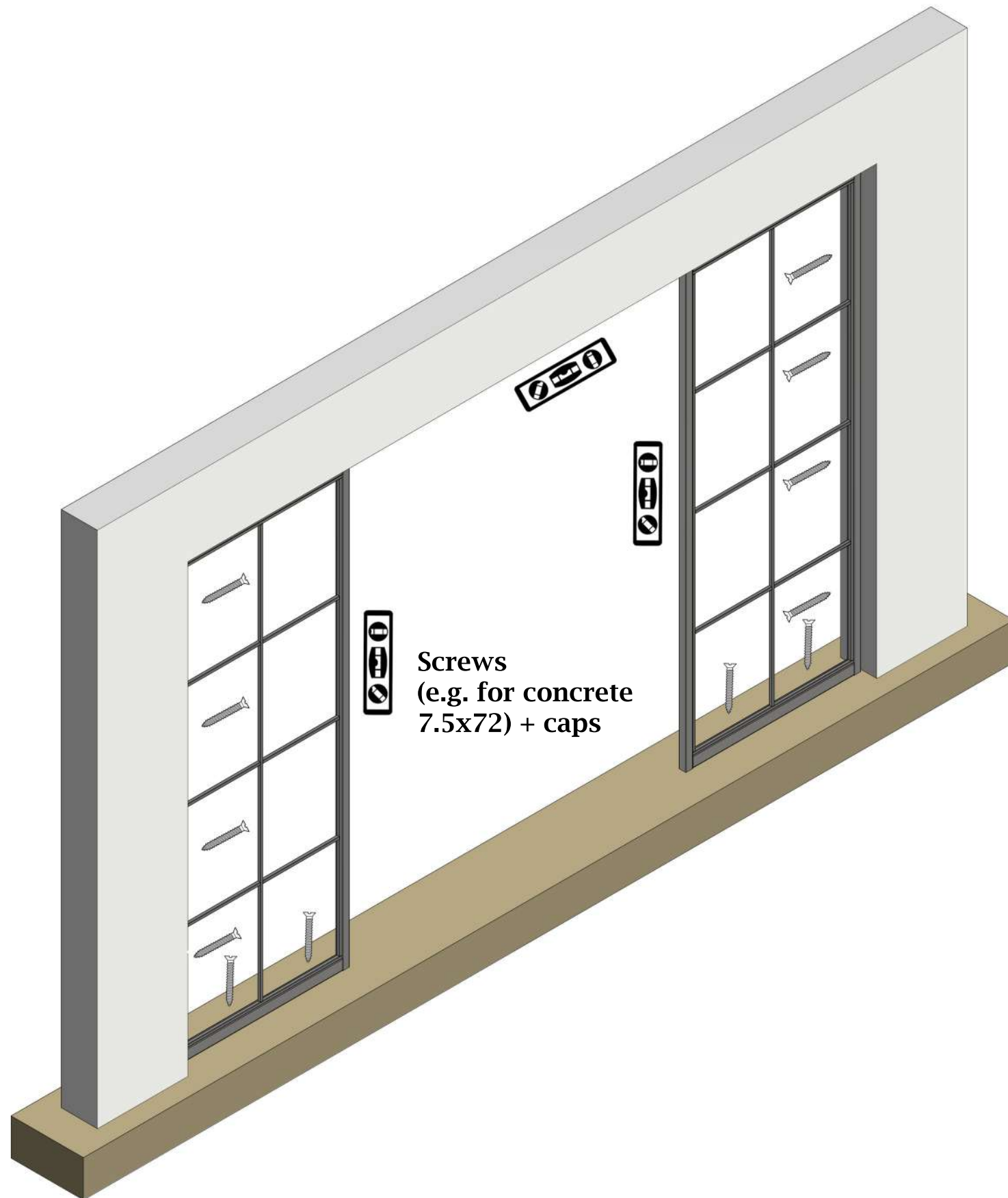

STEP 6

MOUNTING THE ROLLER GUIDE

* Use the roller system manual to instal

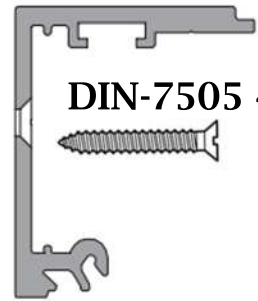
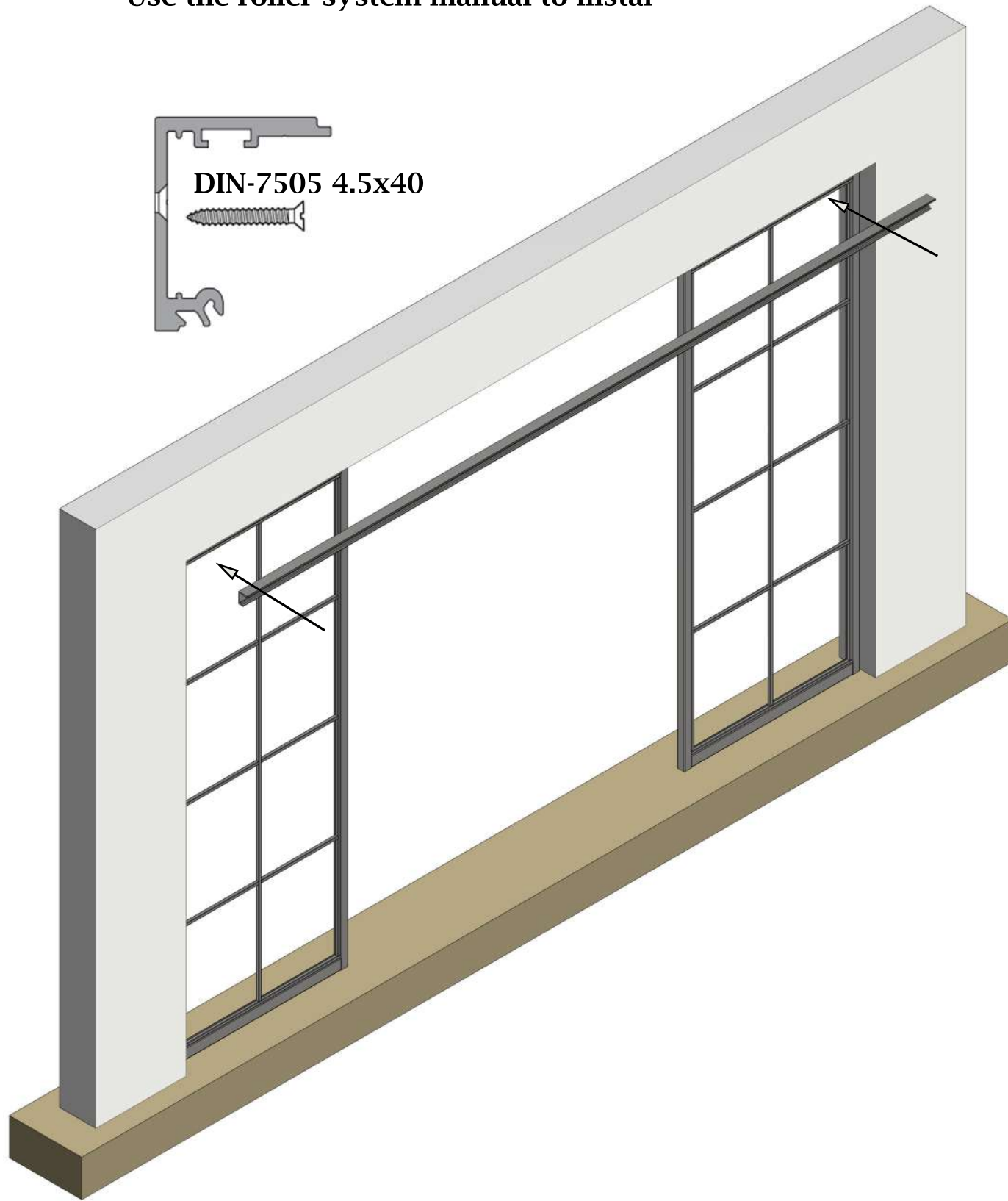

DIN-7505 4.5x40

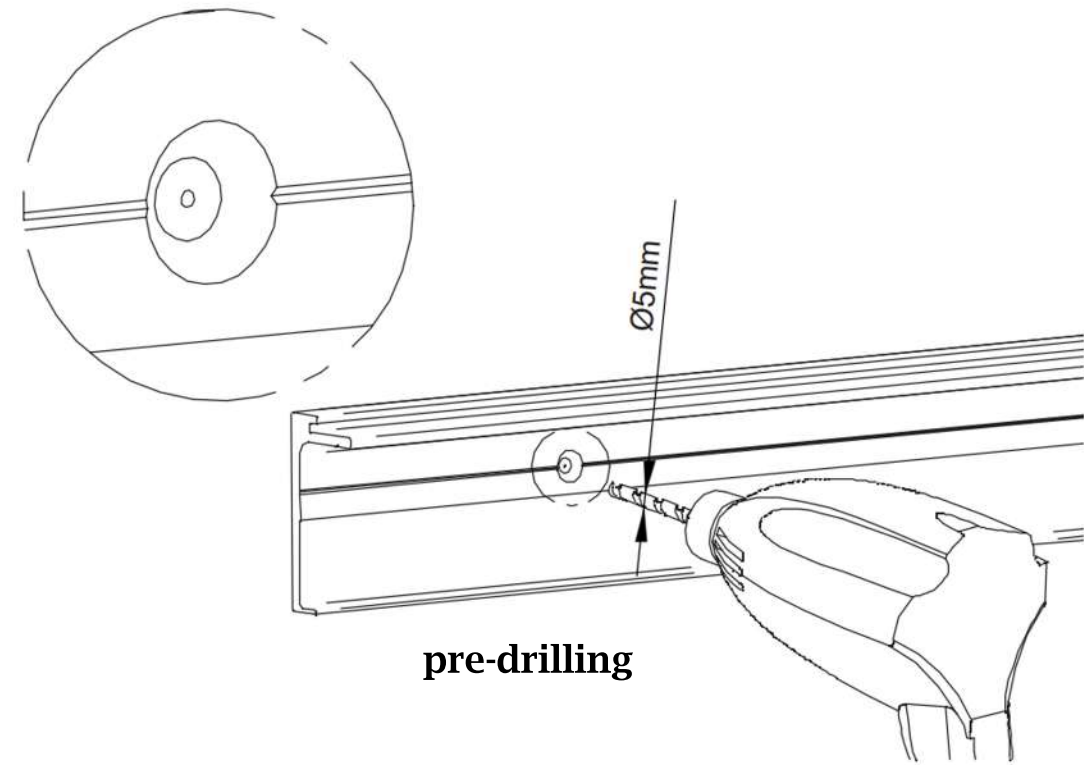

pre-drilling

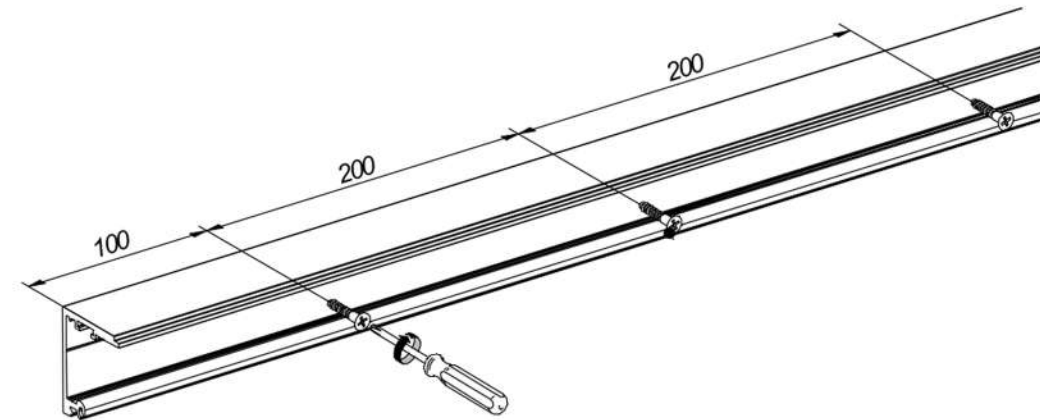

STEP 7

INSTALLING THE SLIDING DOORS' LEAVES

Install the doors' leaves on the roller guide

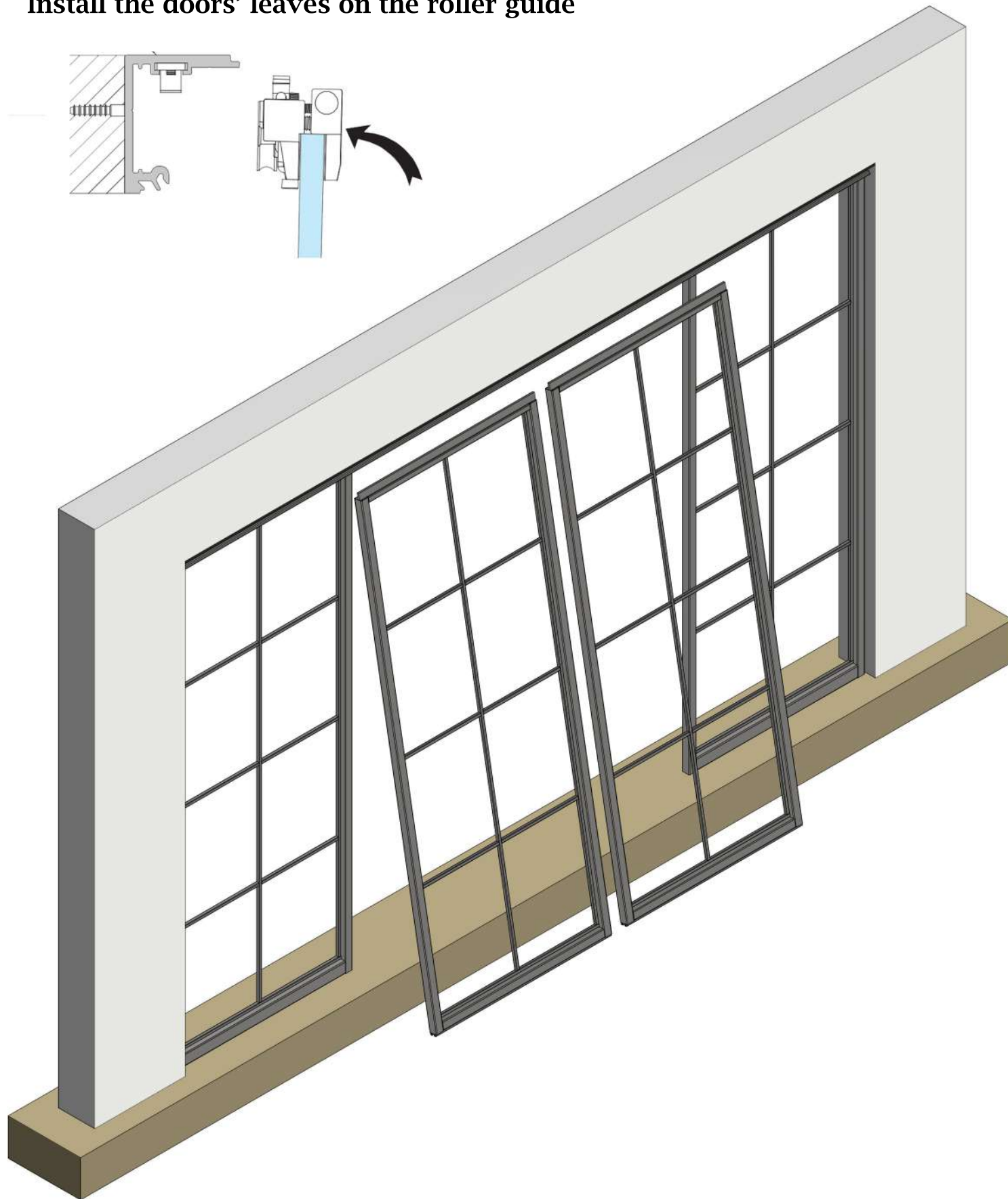

STEP 8

ADJUSTING THE ROLLER SYSTEM

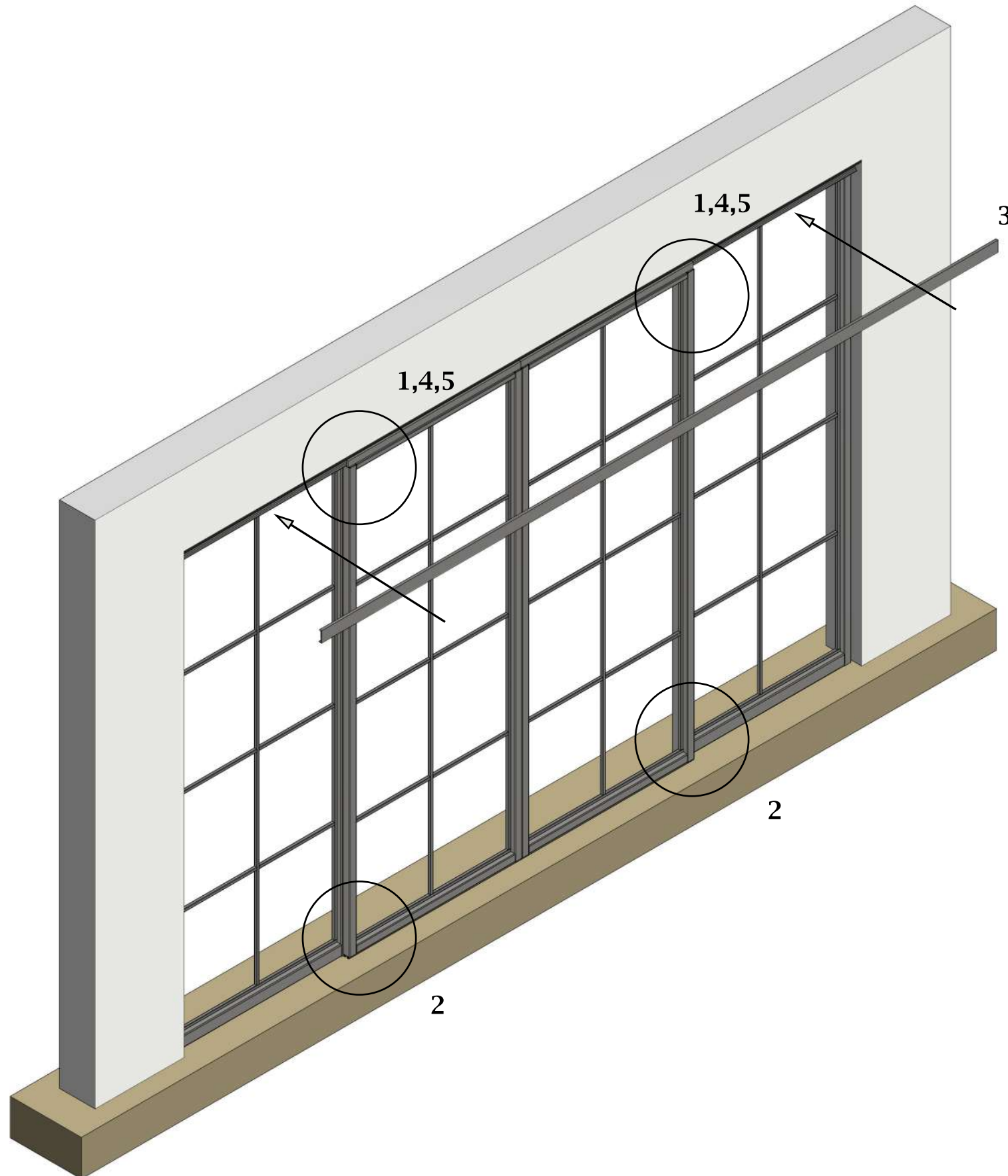

1. Adjust the height

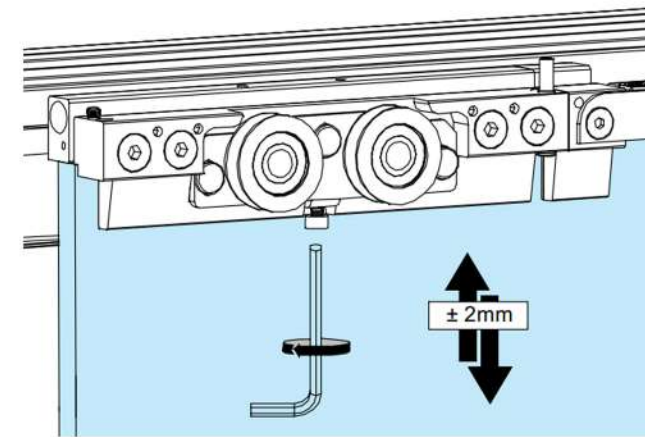

2. Install the guide

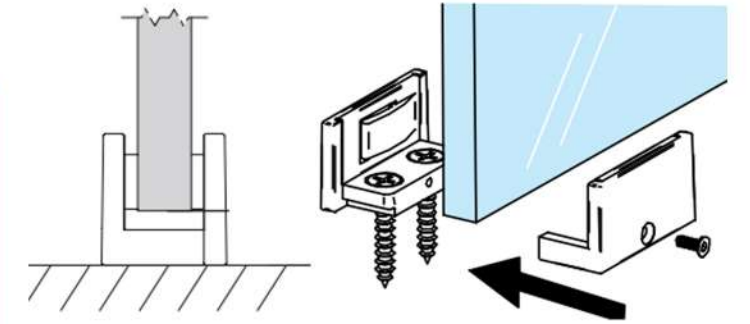

3. Close the track from the sideways

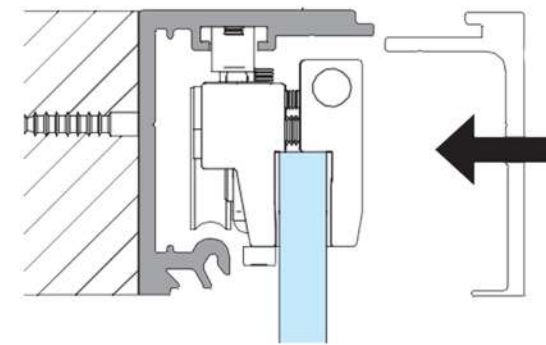

4. Adjust anti-derailment

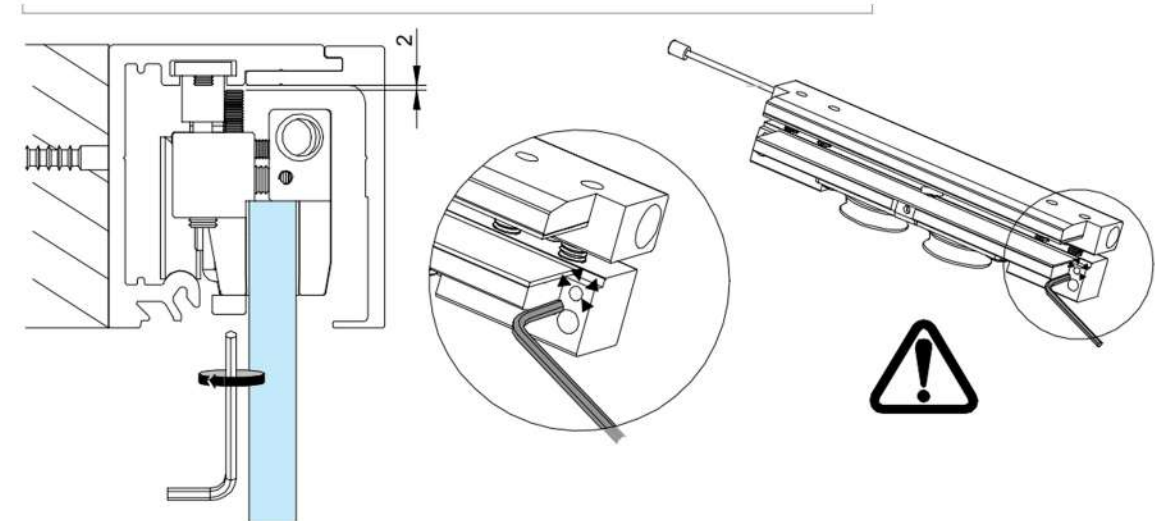

5. Close the track from the bottom

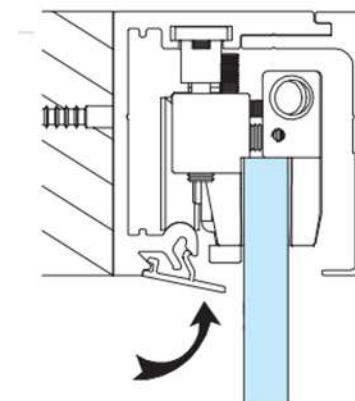

STEP 9

GLASS INSTALLATION

Install the glass and glass frames in sequence with fixation

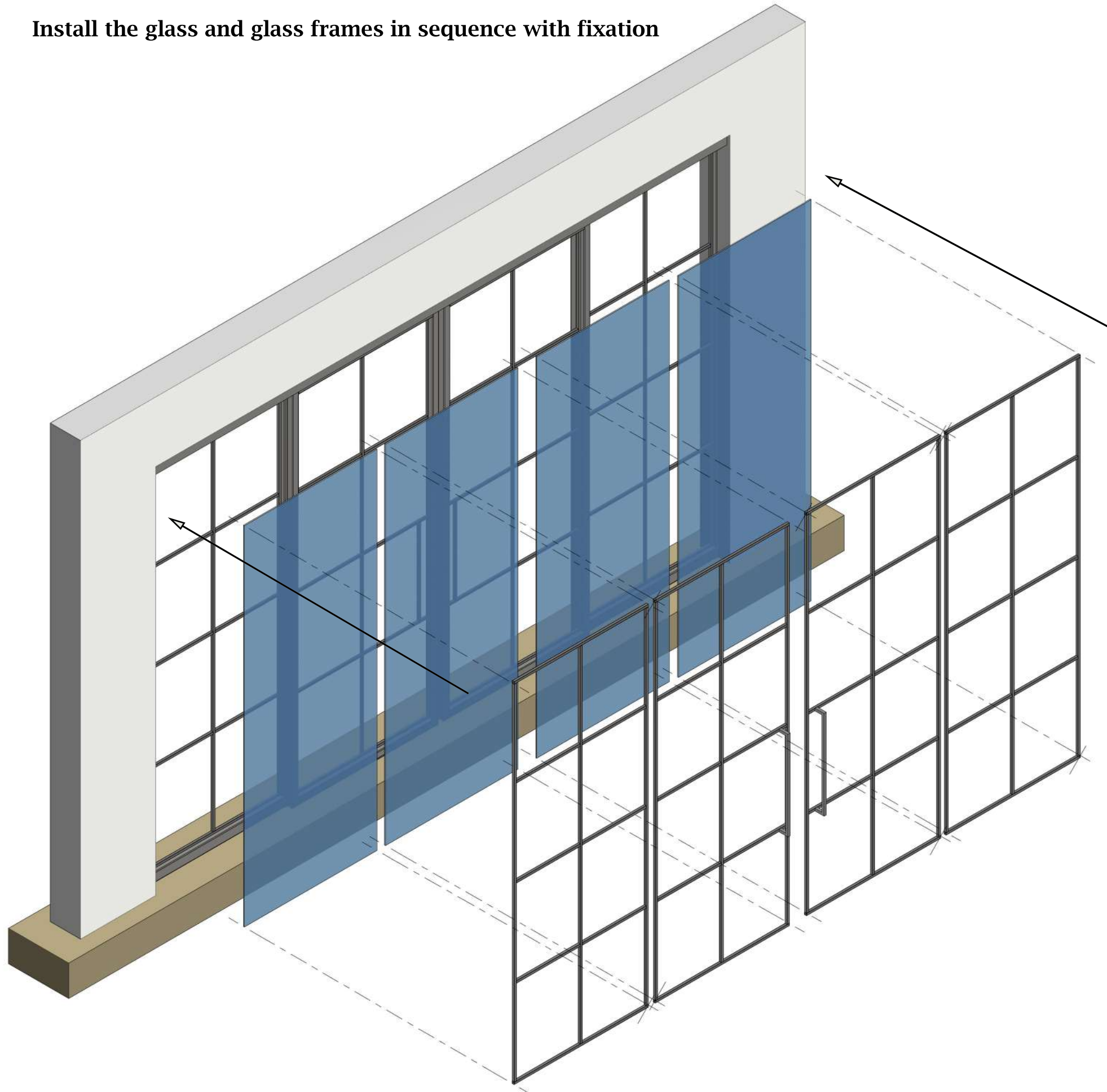

STEP 10

GLASS FRAMES' FIXATION

Fix the frames with the M3 screws

